

LEVELING DEVICES- Low Cost High Value Series No Pad

Low Cost High Value Levelers are available in both stud styles and socket styles, with or without elastomer pad.

Steel and Stainless Steel

Vlier HI-VALUE Stud Style Steel/Stainless Steel Leveling Devices provide an integrally machined stud as part of the ball. Stud Style Bases swivel 15° off the centerline to adjust to uneven surfaces and level machine tools, electronic racks, benches, etc. Zinc plate with gold chromate finish is standard, add '3' to end of part number for new Nickel Finish.

Stainless Steel Leveling Devices offer the advantage of an all-stainless steel design for maximum protection against rust and corrosion.

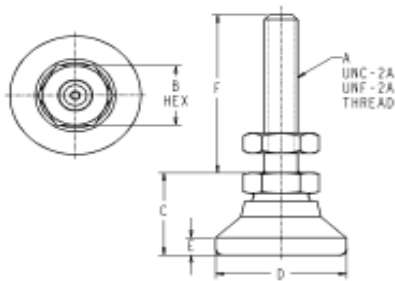

Part No.	Max load (lbs)	A Thread	B Hex	C Height to Hex	D Pad Diameter	E	F Bolt Length
HVP298S	700	10-32	3/8	17/32	3/4	7/64	1
HVP299S	700	10-32	3/8	17/32	3/4	7/64	2
HVP300S	1,100	1/4-20	1/2	45/64	1	5/32	1-1/4
HVP301S	1,100	1/4-20	1/2	45/64	1	5/32	2.5
HVP304S	3,750	3/8-16	5/8	7/8	1-1/4	3/16	2
HVP305S	3,750	3/8-16	5/8	7/8	1-1/4	3/16	4
HVP306S	5,000	1/2-13	3/4	1-1/8	1-7/8	1/4	2
HVP307S	5,000	1/2-13	3/4	1-1/8	1-7/8	1/4	4
HVP308S	6,000	5/8-11	7/8	1-1/4	2-1/2	5/16	2
HVP309S	6,000	5/8-11	7/8	1-1/4	2-1/2	5/16	4
HVP310S	7,200	3/4-10	1-1/16	1-1/2	3	1/2	2
HVP311S	7,200	3/4-10	1-1/16	1-1/2	3	1/2	4
HVP312S	22,000	1-8	1-3/8	1-7/8	4	13/32	4-1/4
HVP313S	22,000	1-8	1-3/8	1-7/8	4	13/32	8

	Max load (lbs)	A Thread	B Hex	C Height to Hex	D Pad Diameter	E	F Bolt Length
Steel Nickel Finish							
HVP298S3	700	10-32	3/8	17/32	3/4	7/64	1
HVP299S3	700	10-32	3/8	17/32	3/4	7/64	2
HVP300S3	1,100	1/4-20	1/2	45/64	1	5/32	1-1/4
HVP301S3	1,100	1/4-20	1/2	45/64	1	5/32	2.5
HVP304S3	3,750	3/8-16	5/8	7/8	1-1/4	3/16	2
HVP305S3	3,750	3/8-16	5/8	7/8	1-1/4	3/16	4
HVP306S3	5,000	1/2-13	3/4	1-1/8	1-7/8	1/4	2
HVP307S3	5,000	1/2-13	3/4	1-1/8	1-7/8	1/4	4
HVP308S3	6,000	5/8-11	7/8	1-1/4	2-1/2	5/16	2
HVP309S3	6,000	5/8-11	7/8	1-1/4	2-1/2	5/16	4
HVP310S3	7,200	3/4-10	1-1/16	1-1/2	3	1/2	2
HVP311S3	7,200	3/4-10	1-1/16	1-1/2	3	1/2	4
HVP312S3	22,000	1-8	1-3/8	1-7/8	4	13/32	4-1/4
HVP313S3	22,000	1-8	1-3/8	1-7/8	4	13/32	8

	Max load (lbs)	A Thread	B Hex	C Height to Hex	D Pad Diameter	E	F Bolt Length
Stainless Steel/ Passivated							
HVSSP298S	700	10-32	3/8	17/32	3/4	7/64	1
HVSSP299S	700	10-32	3/8	17/32	3/4	7/64	2
HVSSP300S	1,100	1/4-20	1/2	45/64	1	5/32	1-1/4
HVSSP301S	1,100	1/4-20	1/2	45/64	1	5/32	2.5
HVSSP304S	3,750	3/8-16	5/8	7/8	1-1/4	3/16	2
HVSSP305S	3,750	3/8-16	5/8	7/8	1-1/4	3/16	4
HVSSP306S	5,000	1/2-13	3/4	1-1/8	1-7/8	1/4	2
HVSSP307S	5,000	1/2-13	3/4	1-1/8	1-7/8	1/4	4
HVSSP308S	6,000	5/8-11	7/8	1-1/4	2-1/2	5/16	2
HVSSP309S	6,000	5/8-11	7/8	1-1/4	2-1/2	5/16	4
HVSSP310S	7,200	3/4-10	1-1/16	1-1/2	3	1/2	2
HVSSP311S	7,200	3/4-10	1-1/16	1-1/2	3	1/2	4
HVSSP312S	22,000	1-8	1-3/8	1-7/8	4	13/32	4-1/4
HVSSP313S	22,000	1-8	1-3/8	1-7/8	4	13/32	8

LEVELING DEVICES- Low Cost High Value Socket Style Without Pad

Low Cost High Value Levelers are available in both stud styles and socket styles, with or without elastomer pad.

Vlier HI-VALUE Socket Style Steel and Stainless Steel Leveling Devices swivel 15° off the centerline to adjust to uneven surfaces and level machine tools, electronic racks, benches, etc. For applications with an existing stud installation. Zinc plate with gold chromate finish is standard add '3' to end of part number for new Steel Nickel Chromate finish.

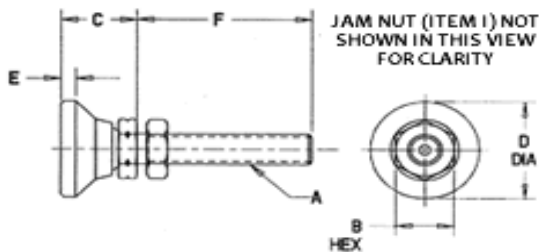

Part No.	Max load KG (lbs)	A Thread	B Hex mm	C Height to Hex +/- .02)	D Dia.	E in.	F Bolt Lgth	M Dia.
Steel								
HVPM6S	240 (525)	M6 x 1-6g .87 MIN FULL THD	10	0.53	0.75	0.11	1	0.63
HVPM8S	375 (825)	M8 x 1.25-6g 1.08 MIN FULL THD	13	0.7	1	0.15	1.25	0.91
HVPM10S	1273 (2800)	M10 x 1.5-6g 1.78 MIN FULL THD	17	0.88	1.25	0.17	2	1.12
HVPM12S	1750 (3750)	M12 x 1.75-6g 1.73 MIN FULL THD	19	1.13	1.88	0.25	2	1.74
HVPM16S	2046 (4500)	M16 x 2-6g 1.68 MIN FULL THD	24	1.25	2.5	0.31	2	2.37
HVPM20S	2455 (5400)	M20 x 2.5-6g 1.65 MIN FULL THD	30	1.5	3	0.5	2	2.87
HVPM24S	7500 (16500)	M24 x 3-6g 3.75 MIN FULL THD	36	1.88	4	0.4	4.25	3.87

	Max load KG (lbs)	A Thread	B Hex mm	C Height to Hex +/- .02)	D Dia.	E in.	F Bolt Lgth	M Dia.
Stainless Steel								
HVSSPM6S	240 (525)	M6 x 1-6g .87 MIN FULL THD	10	0.53	0.75	0.11	1	0.63
HVSSPM8S	375 (825)	M8 x 1.25-6g 1.08 MIN FULL THD	13	0.7	1	0.15	1.25	0.91
HVSSPM10S	1273 (2800)	M10 x 1.5-6g 1.78 MIN FULL THD	17	0.88	1.25	0.17	2	1.12
HVSSPM12S	1750 (3750)	M12 x 1.75-6g 1.73 MIN FULL THD	19	1.13	1.88	0.25	2	1.74
HVSSPM16S	2046 (4500)	M16 x 2-6g 1.68 MIN FULL THD	24	1.25	2.5	0.31	2	2.37
HVSSPM20S	2455 (5400)	M20 x 2.5-6g 1.65 MIN FULL THD	30	1.5	3	0.5	2	2.87
HVSSPM24S	7500 (16500)	M24 x 3-6g 3.75 MIN FULL THD	36	1.88	4	0.4	4.25	3.87